



Tactile Switches Series SPF



PAT. I515757

General Specifications

Circuit :SPST
 Current Rating :50mA
 Voltage Rating :12VDC
 Dielectric Withstanding Voltage :250VAC for 1 minute
 Contact Resistance :100m Ohm Max.(initial)
 Insulation Resistance :100M Ohm Min.
 Operating Force :200gf±50gf
 Total Travel :0.2mm±0.1mm
 Mechanical Life :100,000 cycles Min.
 Function :Momentary
 Operating Temperature :-10 °C ~ +60 °C

Materials

Cap :Polycarbonate (PC)
 Acrylonitrile Butadine Styrene (ABS)
 Polyamide (PA)
 Diffuser :Polycarbonate (PC)
 Housing :Polyamide (PA)
 Acrylonitrile Butadine Styrene (ABS)
 Stem :Polyamide (PA)
 Base :LCP
 Terminal :Bronze with gold plating

PCB layout & Circuit Diagram

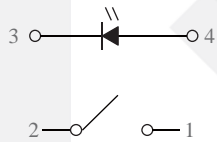

Pin	Function
1	SW COM.
2	SW N.O.
3	LED-
4	LED+

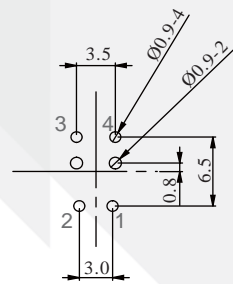

P.C.B. Mounting Holes for SPFSP

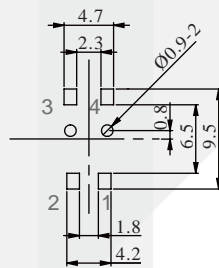

P.C.B. Layout for SPFSC

Dimension

/ SPFSP

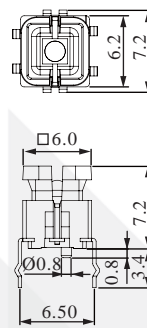

/ SPFSC

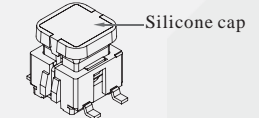
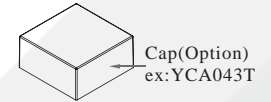
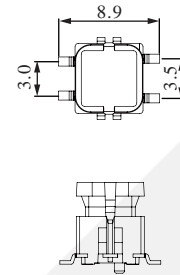

Note:

- ① With silicone cap suit for pick and place machine.
- ② Fit the Cap **AFTER** soldering process.

How to Order

SPF

Terminal Type	
SP	DIP
SC	SMD Silicone cap
SA	SMD PI tape

LED Color	
0	Without LED
1	Red
2	Yellow
3	Green
4	White
5	Pure Green
7	Blue

EXAMPLE : SPFSP7YCA0434



Page 31

6
Page 33

9
6
Page 49

12
6
Page 49

9
Page 39

12
Page 46

From Page 33



ShanPu

Tactile Switches Series SPF

Dimension of Housing

/ Cap Type 1
/ Square Housing

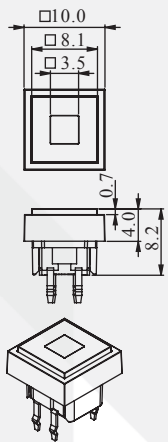

/ Cap Type 2
/ Round Housing

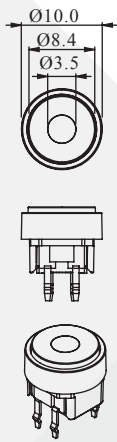

/ Cap Type 3
/ Square Housing

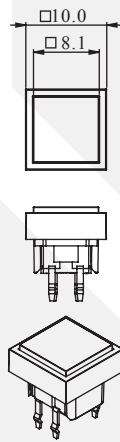

/ Cap Type 4
/ Round Housing

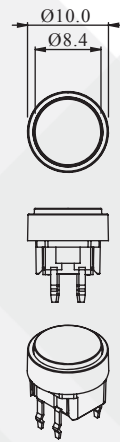

How to Order (Housing)

SPFSP

LED Color

0	Without LED
1	Red
2	Yellow
3	Green
4	White
5	Pure Green
7	Blue

Housing Type

S	Square
R	Round

Housing Color

5	Black
L	Titanium silver

Cap Type with LED

1	
2	

Cap Type without LED

3	
4	

Cap Color

5	Black
9	Grey

EXAMPLE :
SPFSP7R525

Dimension of □9.0 Housing

Features

- Illumination □7.5mm cap.
- Total height 12.0mm.
- Bushing structure embellish front panel.
- Customize graved or printed service.

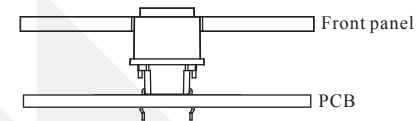

Bushing with tab

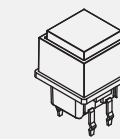
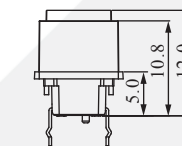
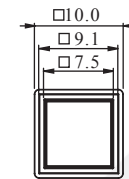

How to Order (□ 9.0 Housing)

SPFSP

LED Color

0	Without LED
1	Red
2	Yellow
3	Green
4	White
5	Pure Green
7	Blue

Housing Color

5	Black
L	Titanium silver

Diffuser color

4	White
---	-------

Cap type

1	Flat
---	------

Cap Color

T	Transparent
---	-------------

EXAMPLE :
SPFSP5L41T



Tactile Switches Series SPF

Dimension of Ø12 Panel Housing

/SPFSP0A551
/SPFSP1A5501-L001

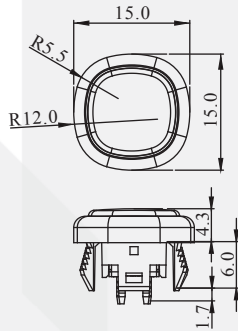

/SPFSS7A5501-L001

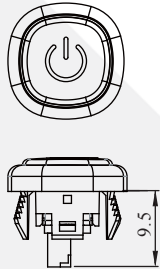

/SPFSP1A5501-L001-1

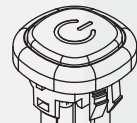
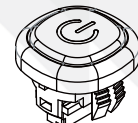
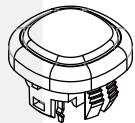
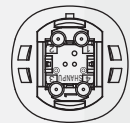
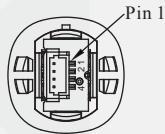
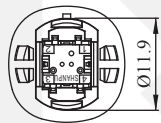
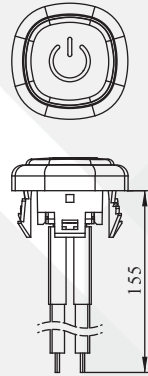

The Connector similar
JST BM04B-SRSS-TB
Applicable Connector:
Conductor pitch / 1.0mm
Conductor width / 0.2mm

Pin	Function	Cable color
1	SW COM.	White
2	SW N.O.	White
3	LED-	Black
4	LED+	Red

UL 1007#22AWG

How to Order Ø12 Panel



SPFSP0A551
Manual solder / Without LED /
Ø12 Black Housing /
Red cap



SPFSP1A5501-L001
Manual solder / Red LED /
Ø12 Black Housing /
Paint Black cap with Marking



SPFSS7A5501-L001
Connector / Blue LED /
Ø12 Black Housing /
Paint Black cap with Marking



SPFSP1A5501-L001-1
Cable UL1007#22AWG / Red LED /
Ø12 Black Housing /
Paint Black cap with Marking

Panel cutting

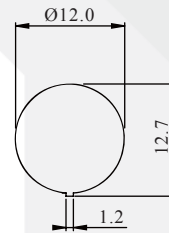

Panel thickness
1.0~3.0mm

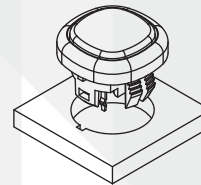

Option for SPFSS□A

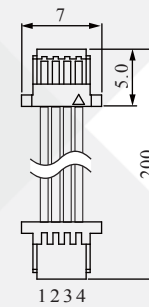

1234
Cable: YCW037
UL1571#28AWG

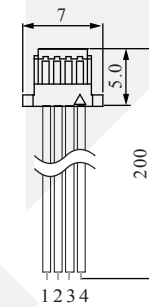

1234
Cable: YCW040
UL1571#28AWG